

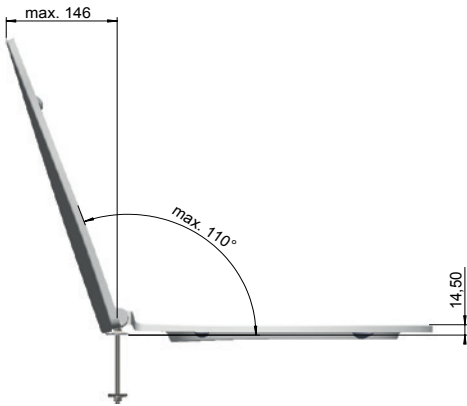

# WC-seat SPIRE

AJ00-0A01 with cover with Push-stainless steel hinge  
white

## Functions:

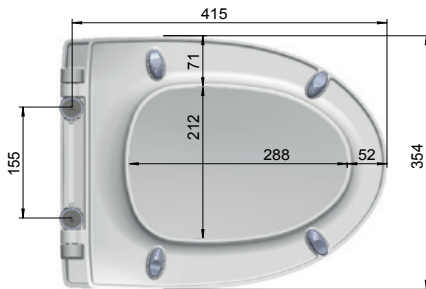
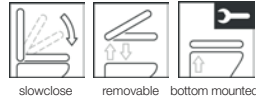

Production since 2017

MKW WC-seat with cover, model SPIRE made from duroplastic with Push-stainless steel hinge.

- Seat and cover close slowly and automatically with just a gentle tap
- Quick and easy to remove and remount
- Sandwich design

## Specifications:

- Distance between hinges ..... 155 mm
- Height ..... 51 mm
- 4 Ellipse buffers (ring) at toilet seat
- 2 Ellipse buffers at cover

- Weight not packed ..... 2,00 kg
- Weight packed ..... 2,30 kg
- Weight of parts - toilet seat ..... 0,75 kg
- Weight of parts - cover ..... 1,10 kg

## Hinges:

- Standard hinge ..... B9AB-0399 Push-stainless steel hinge

## Material:

- Toilet seat ..... Sold-coloured duroplastic
- Buffer ..... TPE (thermoplastic elastomer)
- Standard hinge ..... Stainless steel

**Packaging** ..... MKW single cardboard box,  
490 x 390 x 60 mm